

8.1.5 MT multi-purpose heat shrinkable sleeves

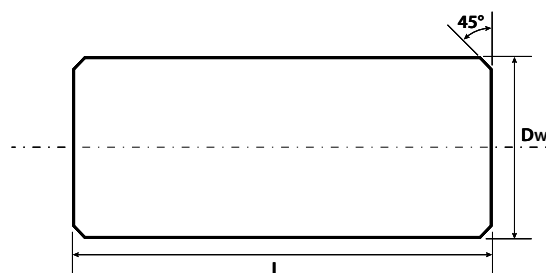

JACKET PIPE external diameter Dz: [mm]	MT SLEEVE +max internal diameter Dw: [mm]	MT SLEEVE Std wall thickness after shrinking s: [mm]	MT SLEEVE length L: [mm]	CATALOGUE No.
90	105 ⁺⁵	3,0	500 / 600 / 700	MT-090L500 /..L700
110	127 ⁺⁵	3,0	500 / 600 / 700	MT-110L500 /..L700
125	141 ⁺⁵	3,0	500 / 600 / 700	MT-125L500 /..L700
140	158 ⁺⁵	3,0	500 / 600 / 700	MT-140L500 /..L700
160	178 ⁺⁵	3,0	500 / 600 / 700	MT-160L500 /..L700
180	197 ⁺⁵	3,0	500 / 600 / 700	MT-180L500 /..L700
200	222 ⁺¹⁰	3,2	500 / 600 / 700	MT-200L500 /..L700
225	249 ⁺¹⁰	3,4	500 / 600 / 700	MT-225L500 /..L700
250	274 ⁺¹⁰	3,6	500 / 600 / 700	MT-250L500 /..L700
280	304 ⁺¹⁰	3,9	500 / 600 / 700	MT-280L500 /..L700
315	341 ⁺¹⁰	4,1	500 / 600 / 700	MT-315L500 /..L700
355	382 ⁺¹⁰	4,5	500 / 600 / 700	MT-355L500 /..L700
400	430 ⁺¹⁵	4,8	500 / 600 / 700	MT-400L500 /..L700
450	480 ⁺¹⁵	5,2	500 / 600 / 700	MT-450L500 /..L700
500	535 ⁺¹⁵	5,6	500 / 600 / 700	MT-500L500 /..L700
520	555 ⁺¹⁵	5,8	500 / 600 / 700	MT-520L500 /..L700
560	595 ⁺¹⁵	6,0	500 / 600 / 700	MT-560L500 /..L700
630	665 ⁺²⁰	6,6	700	MT-630L700
670	705 ⁺²⁰	6,9	700	MT-670L700
710	750 ⁺²⁰	7,2	700	MT-710L700
780	820 ⁺²⁰	7,8	700	MT-780L700
800	845 ⁺²⁰	7,9	700	MT-800L700
900	945 ⁺²⁰	8,7	700	MT-900L700
950	995 ⁺²⁰	9,1	700	MT-950L700
1000	1045 ⁺²⁰	9,4	700	MT-1000L700
1100	1150 ⁺²⁵	10,2	700	MT-1100L700
1200	1250 ⁺²⁵	11,0	700	MT-1200L700
1300	1355 ⁺³⁰	11,8	700	MT-1300L700
1400	1460 ⁺³⁰	12,5	700	MT-1400L700

* Joints' diameter tolerance +/- 1,0mm

* Joints' length tolerance +/- 10mm

** Other lengths of MT sleeves available on request

Multi-purpose (non-cross-linked) heat-shrinkable sleeves are used as:

- classic heat-shrinkable joints when used with mastic and/or hot-melt adhesive,
- repair joints, that once cut longitudinally can be welded again by an extruder,
- sliding sleeves for electro-fusion welding joints in combination with EG40 heating elements,
- atypical joints, that can be freely cut and drilled for welding plugs, in any spot desired.

MT sleeves should be stored and transported in upright position to avoid ovalization. Maximal temperature during storage and transport shall not exceed 35°C. On customer's demand the MT sleeves can be wrapped in white LDPE foil (MT+F).