

### 8.5.2 ECD1 heat-shrinkable, cross-linked end caps, for symmetric double pipes.

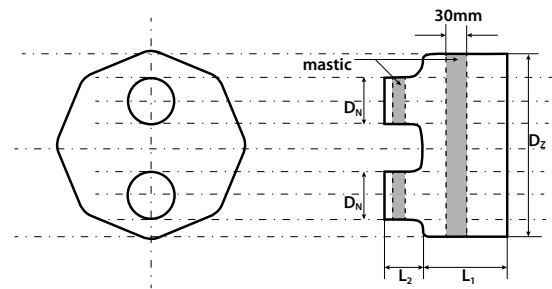

JACKET PIPE external diameter Dz: [mm]	Shrinkage on the jacket pipe max / min Dz <sub>max</sub> / Dz <sub>min</sub> : [mm]	Shrinkage on the steel pipe external max / min DN <sub>max</sub> / DN <sub>min</sub> : [mm]	APPLICATION		CATALOGUE No.
			jacket / steel pipe Dz / 2 x DN: [mm]	s: [mm]	
125	133 / 95	32 / 22	125 / 2 x 20		ECD1-125/20+20
140	150 / 110	32 / 22	140 / 2 x 20	18	ECD1-140/20+20
140	150 / 110	38 / 27	140 / 2 x 25	18	ECD1-140/25+25
160	170 / 120	28 / 27	160 / 2 x 25	18	ECD1-160/25+25
160	170 / 120	48 / 34	160 / 2 x 32	18	ECD1-160/32+32
160	170 / 120	54 / 39	160 / 2 x 40	18	ECD1-160/40+40
180	190 / 130	48 / 34	180 / 2 x 32	18	ECD1-180/32+32
180	190 / 130	54 / 39	180 / 2 x 40	18	ECD1-180/40+40
200	209 / 140	70 / 47	200 / 2 x 50	20	ECD1-200/50+50
225	234 / 180	70 / 47	225 / 2 x 50	20	ECD1-225/50+50
225	234 / 180	82 / 58	225 / 2 x 65	20	ECD1-225/65+65
250	260 / 195	82 / 58	250 / 2 x 65	20	ECD1-250/65+65
250	260 / 195	96 / 78	250 / 2 x 80	25	ECD1-250/80+80
280	290 / 215	96 / 78	280 / 2 x 80	25	ECD1-280/80+80
315	328 / 240	124 / 98	315 / 2 x 100	25	ECD1-315/100+100
355	370 / 260	124 / 98	355 / 2 x 100	25	ECD1-355/100+100
400	415 / 310	149 / 125	400 / 2 x 125	30	ECD1-400/125+125
450	465 / 390	149 / 125	450 / 2 x 125	30	ECD1-450/125+125
450	465 / 390	182 / 148	450 / 2 x 150	40	ECD1-450/150+150
500	520 / 465	182 / 148	500 / 2 x 150	40	ECD1-500/150+150
560	575 / 480	238 / 179	560 / 2 x 200	45	ECD1-560/200+200
630	655 / 530	238 / 179	630 / 2 x 200	45	ECD1-630/200+200

\* The color marked ECD1 end caps for pre-insulated pipes with Insulation "plus type"