

8.1.7a MTM heat shrinkable joints with mastic

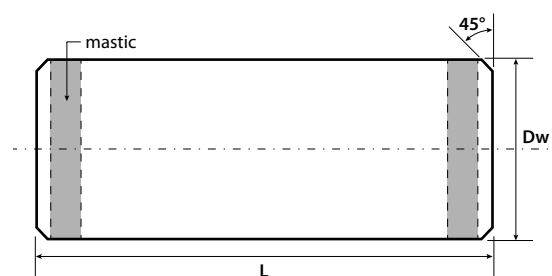

JACKET PIPE external diameter Dz: [mm]	MTM SLEEVE +max internal diameter Dw: [mm]	MTM SLEEVE Std wall thickness after shrinking s: [mm]	MTM SLEEVE length L: [mm]	CATALOGUE No.
90	105 ⁺⁵	3,0	500 / 600 / 700	MTM-090L500W /..L700W
110	127 ⁺⁵	3,0	500 / 600 / 700	MTM-110L500W /..L700W
125	141 ⁺⁵	3,0	500 / 600 / 700	MTM-125L500W /..L700W
140	158 ⁺⁵	3,0	500 / 600 / 700	MTM-140L500W /..L700W
160	178 ⁺⁵	3,0	500 / 600 / 700	MTM-160L500W /..L700W
180	197 ⁺⁵	3,0	500 / 600 / 700	MTM-180L500W /..L700W
200	222 ⁺¹⁰	3,2	500 / 600 / 700	MTM-200L500W /..L700W
225	249 ⁺¹⁰	3,4	500 / 600 / 700	MTM-225L500W /..L700W
250	274 ⁺¹⁰	3,6	500 / 600 / 700	MTM-250L500W /..L700W
280	304 ⁺¹⁰	3,9	500 / 600 / 700	MTM-280L500W /..L700W
315	341 ⁺¹⁰	4,1	500 / 600 / 700	MTM-315L500W /..L700W
355	382 ⁺¹⁰	4,5	500 / 600 / 700	MTM-355L500W /..L700W
400	430 ⁺¹⁵	4,8	500 / 600 / 700	MTM-400L500W /..L700W
450	480 ⁺¹⁵	5,2	500 / 600 / 700	MTM-450L500W /..L700W
500	535 ⁺¹⁵	5,6	500 / 600 / 700	MTM-500L500W /..L700W
520	555 ⁺¹⁵	5,8	500 / 600 / 700	MTM-520L500W /..L700W
560	595 ⁺¹⁵	6,0	500 / 600 / 700	MTM-560L500W /..L700W
630	665 ⁺²⁰	6,6	700	MTM-630L700W
670	705 ⁺²⁰	6,9	700	MTM-670L700W
710	750 ⁺²⁰	7,2	700	MTM-710L700W
780	820 ⁺²⁰	7,8	700	MTM-780L700W
800	845 ⁺²⁰	7,9	700	MTM-800L700W
900	945 ⁺²⁰	8,7	700	MTM-900L700W
950	995 ⁺²⁰	9,1	700	MTM-950L700W
1000	1045 ⁺²⁰	9,4	700	MTM-1000L700W
1100	1150 ⁺²⁵	10,2	700	MTM-1100L700W
1200	1250 ⁺²⁵	11,0	700	MTM-1200L700W
1300	1355 ⁺³⁰	11,8	700	MTM-1300L700W
1400	1460 ⁺³⁰	12,5	700	MTM-1400L700W

* Joints' diameter tolerance +/- 1,0mm

* Joints' length tolerance +/- 10mm

** Other lengths of MTM sleeves available on request

MTM joint is to be placed on pre-insulated pipeline prior to welding of the steel pipes. Both ends of the joint are to be shrunk with delicate flame of gas burner. Due to the single sealing the MTM joint is to be used where ground water level is below the level of pre-insulated pipes and where the soil is not polluted with oil products and chemicals.

Set of MTM joint contains:

- heat shrinkable sleeve with pre-applied mastic
- ventilation plugs – 2 pieces
- weldable plugs – 2 pieces



MTM joints are wrapped in white LDPE foil and should be stored and transported in upright position to avoid ovalization. Maximal temperature during storage and transport shall not exceed 35°C.

Additional accessories: during assembly of the joints components of polyurethane foam (PUR) are to be used. When ordering please provide information if the joints are to be delivered together with PUR foam.