

8.1.9 MTF1 cross-linked heat shrinkable flexible elbow joints (Flex Bend type 0-90°)

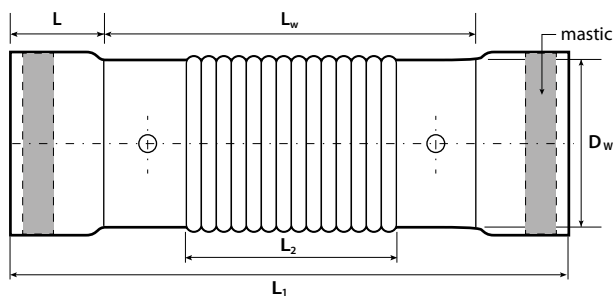

JACKET PIPE external diameter Dz: [mm]	MTF1 JOINT min. int. diameter Dw: [mm]	MTF1 length L1: [mm]	MTF1 length of elastic part L2: [mm]	STEEL PIPE DN/external dia. x wall thickness D x s: [mm]	STEEL PIPE radius R: [mm]	CATALOGUE No.
90	104	980	560	20 / 26,9 x 2,6 25 / 33,7 x 2,6	200	MTF1-090L980R
110	125	980	560	32 / 42,4 x 2,9 40 / 48,3 x 2,9	200	MTF1-110L980R
125	140	1050	630	50 / 60,3 x 3,2	240	MTF1-125L1050R
140	155	1050	630	65 / 76,1 x 3,2	240	MTF1-140L1050R
160	175	1050	630	80 / 88,9 x 3,6	240	MTF1-160L1050R
180	196	1050	630	80 / 88,9 x 3,6	240	MTF1-180L1050R
200	216	1120	700	100 / 114,3 x 3,6	286	MTF1-200L1120R
225	242	1220	800	125 / 139,7 x 4,0	349	MTF1-225L1220R
250	267	1340	920	150 / 168,3 x 4,5	421	MTF1-250L1340R

***MTF1 280, 315, 355 400 mm in the pipeline**

The MTF1 flexible elbow joints, after prior heating up of the flexible middle section allow to shape any desired angle in 0-90 degrees range. In case of unforeseen collisions or obstacles during construction of district heating pipeline, they allow the change of its course.

MTF1 elbow joint can be used in all soil conditions.

Set of MTF1 joint contains:

- cross-linked joint with flexible middle section and heat shrinkable ends, with pre-applied mastic

Additional accessories:

- ventilation plugs – 2 pcs
- expanding, spiking plugs, two-parts – 2 pcs
- FOPS patches protecting from infiltration of humidity through the foaming openings – 2 pcs



During assembly of the joints components of polyurethane foam (PUR) are to be used. When ordering please provide information if the joints are to be delivered together with PUR foam.

MTF1 joints are wrapped in white LDPE foil and should be stored and transported in upright position to avoid ovalization. Maximal temperature during storage and transport must not exceed 35°C.

NOTE: due to larger internal volume of the flexible elbow joint the components of PUR foam have to be dedicated for this type of products. Do not use foam designed for standard (plain) joints.