

8.1.6 MTr heat-shrinkable joints covering two adjacent diameters (double expanded), straight shaped

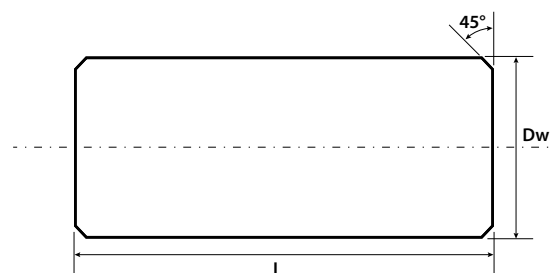

JACKET PIPE external diameter Dz_2/Dz_1 : [mm]	MTr SLEEVE +max internal diameter Dw: [mm]	MTr SLEEVE Std wall thickness after shrinking s: [mm]	MTr SLEEVE length L: [mm]	CATALOGUE No.
90/110	127 ⁺⁵	3,0	650 / 700	MTr-090/110L650 /..L700
110/125	141 ⁺⁵	3,0	650 / 700	MTr-110/125L650 /..L700
125/140	158 ⁺⁵	3,0	650 / 700	MTr-125/140L650 /..L700
140/160	176 ⁺⁵	3,0	650 / 700	MTr-140/160L650 /..L700
160/180	196 ⁺⁵	3,0	650 / 700	MTr-160/180L650 /..L700
180/200	220 ⁺¹⁰	3,2	650 / 700	MTr-180/200L650 /..L700
200/225	247 ⁺¹⁰	3,4	650 / 700	MTr-200/225L650 /..L700
225/250	272 ⁺¹⁰	3,6	650 / 700	MTr-225/250L650 /..L700
250/280	302 ⁺¹⁰	3,9	650 / 700	MTr-250/280L650 /..L700
280/315	339 ⁺¹⁰	4,1	650 / 700	MTr-280/315L650 /..L700
315/355	380 ⁺¹⁰	4,5	650 / 700	MTr-315/355L650 /..L700
355/400	430 ⁺¹⁵	4,8	700	MTr-355/400L700
400/450	480 ⁺¹⁵	5,2	700	MTr-400/450L700
450/500	535 ⁺¹⁵	5,6	700	MTr-450/500L700
500/520	555 ⁺¹⁵	5,8	700	MTr-500/520L700
500/560	595 ⁺¹⁵	6,0	700	MTr-500/560L700
520/560	595 ⁺¹⁵	6,0	700	MTr-520/560L700
560/630	665 ⁺²⁰	6,6	700	MTr-560/630L700
630/670	705 ⁺²⁰	6,9	700	MTr-630/670L700
730/710	750 ⁺²⁰	7,2	700	MTr-630/710L700
670/710	750 ⁺⁵⁰	7,8	700	MTr-670/710L700

* Joints' diameter tolerance +/- 1,0mm

* Joints' length tolerance +/- 10mm

** Other lengths of MTr sleeves available on request

Heat shrinkable double-expanded joints straight shaped, covering two adjacent diameters, used as:

- regular heat shrinkable joints in combination with mastic and/or hot melt adhesive,
- repair joints, which after longitudinal cutting can be welded again with an extruder,
- electro-fusion welding in combination with the heating elements,
- atypical joints, that can be freely cut and drilled for welding plugs, in any spot desired

MTr joints should be stored and transported in upright position. The maximum temperature during transport and storage must not exceed 35°C.

On customer's demand the MTr joints can be wrapped in white LDPE foil (MTr+F).